

# EX-36 F series

## Explosion-proof fixed analogue camera

- ✓ ATEX and IECEx certified for gas and dust
- ✓ Single integrated flexible conduit tail
- ✓ Corrosion protected 316L stainless steel
- ✓ Low maintenance
- ✓ 550 TVL PAL or NTSC CCD camera
- ✓ 36 x zoom 12 x digital
- ✓ Integrated heater
- ✓ Optional wiper, washer tank and termination box
- ✓ Optional: Direct to Fiber



### Description

The EX-BC36 F is a 36x zoom analogue camera built in a fixed camera housing designed for use in hazardous areas in onshore, offshore, marine and heavy industrial environments. The camera housing is constructed from electro-polished 316L stainless steel for maximum corrosion protection and is fitted as standard with sunshield and thermostatically controlled heater element. Optionally the camera can be connected direct to optical fiber.

### ATEX and IECEx certified

The EX-BC36 F is an Ex d (flame proof) housing suited to be used in hazardous areas, zone 1, 2 for gas and zone 21 and 22 for dust environments.

### Integrated analogue zoom box camera

Fitted as standard, the EX-BC36 F is equipped with a 36x optical zoom analogue day/ night camera. The 36x zoom realizes the optimum field of view in any situation. The camera is controlled by Pelco D commands over RS485.

### Image enhancement

The camera provides automatic day/night functionality for use in low light situations. The WDR brings out details in dark areas and details in the bright areas by combining the best of two exposures.

### Washer/Wiper option

The EX-BC36 F-WW version is standard equipped with wiper and prepared for a washer hose and nozzle. A pressurized 10 litre washer tank, including hose and nozzle is sold separately.

### Conduit choices

To simplify installation in hazardous areas the Ex-fixed camera is standard fitted with a 3m conduit, including wiring. TKH Security Solutions offers an 316L Ex e termination box for easy, but safe and secure installation. The conduit is available in 3, 5, or 10 m.

### Direct to fiber

As an option the camera can be fitted with a optical fiber connection (2SM). The duplex single mode fiber is preconfigured with dual LC connectors.

# EX-BC36 F series

Explosion-proof fixed analogue camera

## Camera housing

Certification	ATEX, IECEx II 2 G Ex d op pr IIC T6 II 2 D Ex tb IIIC T85°C Db IP66/67
Ingress protection rating	IP66/ IP67
Body material	Electro-polished 316L stainless steel
Conduit	20 mm low fire hazard, liquid tight conduit Galvanised steel core.Zero halogen
Glands	2x M20 Brass flameproof barrier glands, pre-assembled
Length	3 meter. Optional 5 or 10 m
Sunshield	Standard
Internal demister/heater	Standard
Wiper	Optional (F-WW version only)
Washer system	Optional (EX-WP10 Ex e 24 or EX-WP10 Ex d 24)
Operating temperature	-20 °C to +60 °C
“Dry heat” test	+75 °C, 2 days
Weight	
EX-BC36 F 24 3C	12 kg
EX-BC36 F-WW 24 3C	14 kg

## Electrical

Zoom, wiper and washer control	2-wire RS485, Pelco D, 2400 baud
Supply voltage	24 V~ 50/60 Hz; Optional 115 V~ 50/60 Hz; 230 V~ 50/60 Hz
Power consumption	95 W maximum
Electrical connections	3 wire power cable from the conduit, 0.75 mm <sup>2</sup>

## Camera

Image sensor	1/4” Ex-View HAD CCD
Effective pixels	380,000 (NTSC) or 440,000 (PAL)
Shutter speed	1/3 - 1/10000 s
Minimum scene illumination	0.1 lux (colour), 0.01 lux (b/w), F/1.6
Dynamic range (WDR)	90 dB
Lens	36x Optical zoom, F/1.6 (W), F5 (T); 12x digital zoom
Lens focal length	3.4 mm (W) – 122.4 mm (T)
Horizontal field of view	57.8° (W) – 1.7° (T)
Features	WDR, (3D/2D) noise,
Exposure	Auto (iris)
Day/Night (IR-cut filter)	Auto

# EX-BC36 F series

Explosion-proof fixed analogue camera

## Video

Component Video	/P version for PAL /N version for NTSC
Resolutions	550 TVL
Video frame rate	/P version: 25 fps /N version: 30 fps
Video output	RG179 75 $\Omega$ coax from the conduit

## Order information

EX-BC36/P F 24 3C	Ex 316L fixed analogue, 36x PAL 24Vac 3m conduit 20 mm M20
EX-BC36/P F 24 2SM 3C	Ex 316L fixed analogue, 36x PAL 24Vac, 2SM 3m conduit 20 mm M20
EX-BC36/P F-WW 24 3C	Ex 316L fixed wiper analogue, 36x PAL 24Vac 3m conduit 20 mm M20
EX-BC36/P F-WW 24 2SM 3C	Ex 316L fixed wiper analogue, 36x PAL 24Vac, 2SM 3m conduit 20 mm M20
EX-BC36/N F 24 3C	Ex 316L fixed analogue, 36x NTSC 24Vac 3m conduit 20 mm M20
EX-BC36/N F 24 2SM 3C	Ex 316L fixed analogue, 36x NTSC 24Vac, 2SM 3m conduit 20 mm M20
EX-BC36/N F-WW 24 3C	Ex 316L fixed wiper analogue, 36x NTSC 24Vac 3m conduit 20 mm M20
EX-BC36/N F-WW 24 2SM 3C	Ex 316L fixed wiper analogue, 36x NTSC 24Vac, 2SM 3m conduit 20mm M20
<i>For 115 Vac or 230 Vac option</i>	<i>Replace 24 with 115 or 230 respectively</i>
<i>For 5 or 10 meter conduit</i>	<i>Replace 3C with 5C or 10C respectively</i>

# EX-BC36 F series

Explosion-proof fixed analogue camera

## Accessories

EX pole mounting adapter F



316L pole mounting adapter for EX wall mounting bracket F

EX wall mounting bracket F



316L wall mounting bracket for EX fixed camera housings

EX Pole Top Mounting F



316L Pole TOP Mounting bracket for EX fixed camera housing

EX-WP10 Ex d 24  
(EX-WP10 Ex e 24)



10 liters pressurized washer tank, 316L cabinet, Ex d (or Ex e) solenoid

Ex e termination box IP  
(Ex e termination box fiber)



316L Ex e termination box for IP camera  
(316L Ex e termination box for fiber cameras)

## Maintenance & replacement kits

EX/SA-MK Wiper

Maintenance kit for the wiper: Rubber blade and support

EX/SA-Wiper

Replacement for Stainless steel wiper (complete assembly)

EX-MK fixed

Maintenance kit EX fixed camera: O-Ring, screws, desiccant bags

# EX-BC36 F series

Explosion-proof fixed analogue camera

Dimensions EX-BC36 F series:

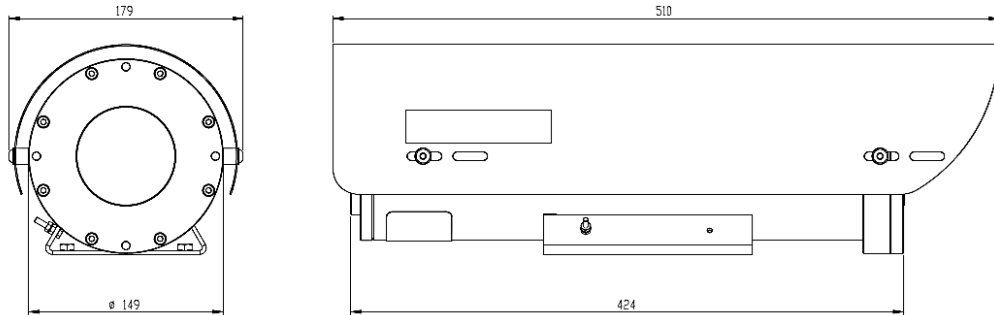

Dimensions EX-BC36 F-WW series:

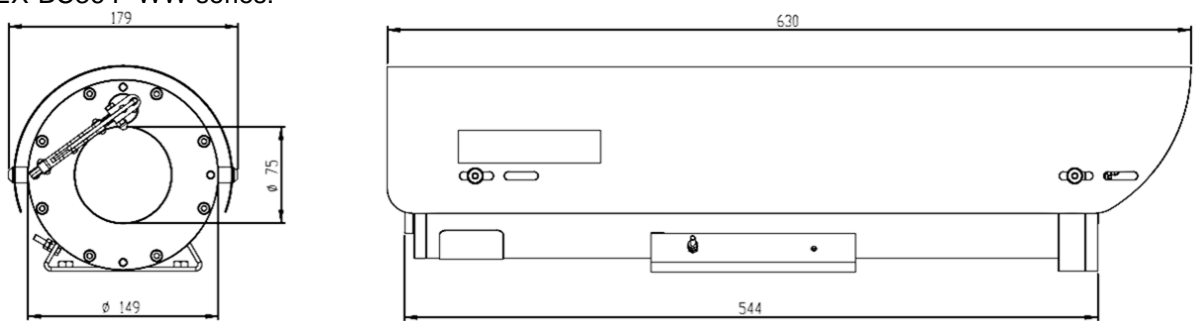

Mounting pattern:

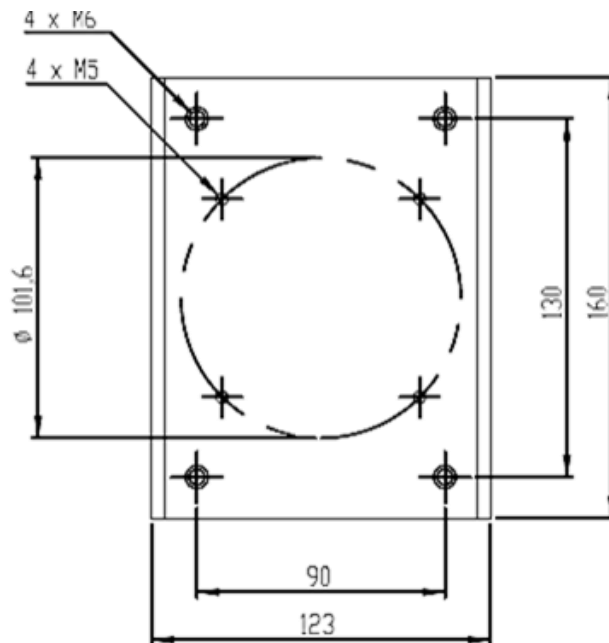

All dimensions in mm



The quality management system used in the development, production, sales, and support of this product is ISO 9001:2008 certified by LRQA.  
© Sigura B.V. 2017 - Version 1.0 - Subject to modification.

